

Woven Paper Egg

Supplies

- Easter egg template
- Strips of different coloured wrapping paper or card, 2cm wide
- A4 sized coloured card
- A4 paper
- Scissors



- Glue stick
- Ribbon
- Hole punch

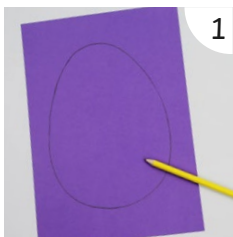

1 Draw around the egg template onto coloured card

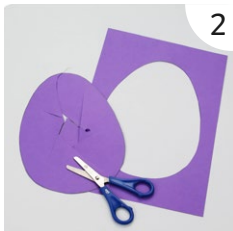

2 Cut the egg shape out of the middle of the card, without damaging the outer rim. This would leave you with an A4 frame of card with an egg shape cut out of it.



3 Cut strips of wrapping paper into two sets; one long enough for the width of the card and one long enough for the length of the card.



4 Place the long strips of wrapping paper vertically onto the A4 paper. Glue them down at one end only.



5 Using the other strips of wrapping paper, weave these over and under the vertical strips of paper.

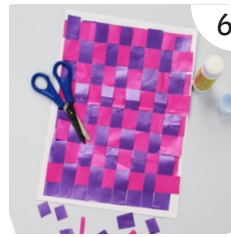

6 Once the A4 paper is covered, glue all the edges of the woven paper down. Then trim the excess paper off to be flush with the A4 sheet.



7 Take the card egg frame and spread glue onto one side of it. Then stick this down on top of the woven sheet.



8 Finally, make a hole at the top of the egg frame using a hole punch.



Woven Paper Egg



Supplies

- Easter egg template
- Strips of different coloured wrapping paper or card, 2cm wide
- A4 sized coloured card
- A4 paper
- Scissors
- Glue stick
- Ribbon
- Hole punch



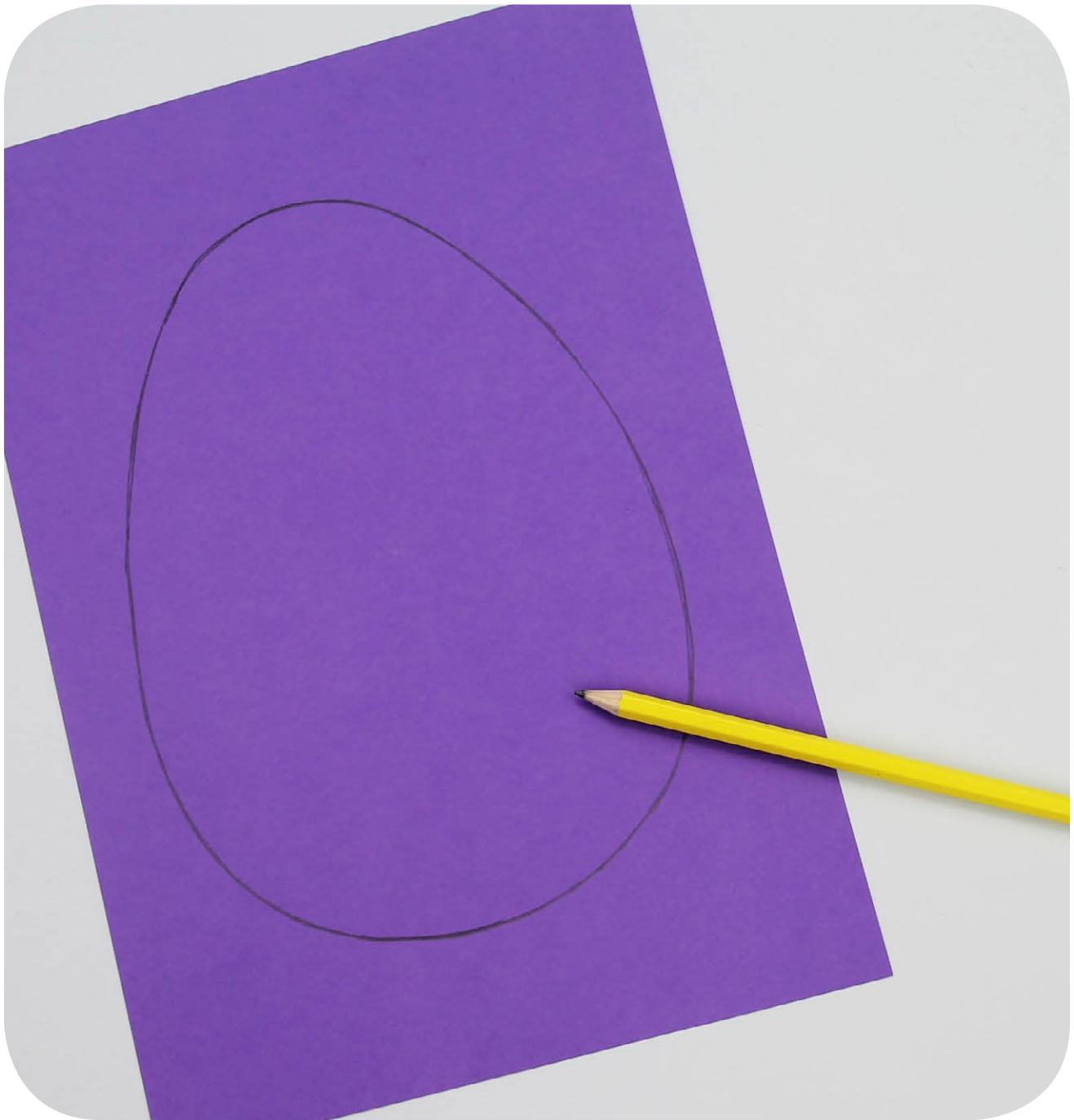

Step 1.

Draw around the egg template onto coloured card

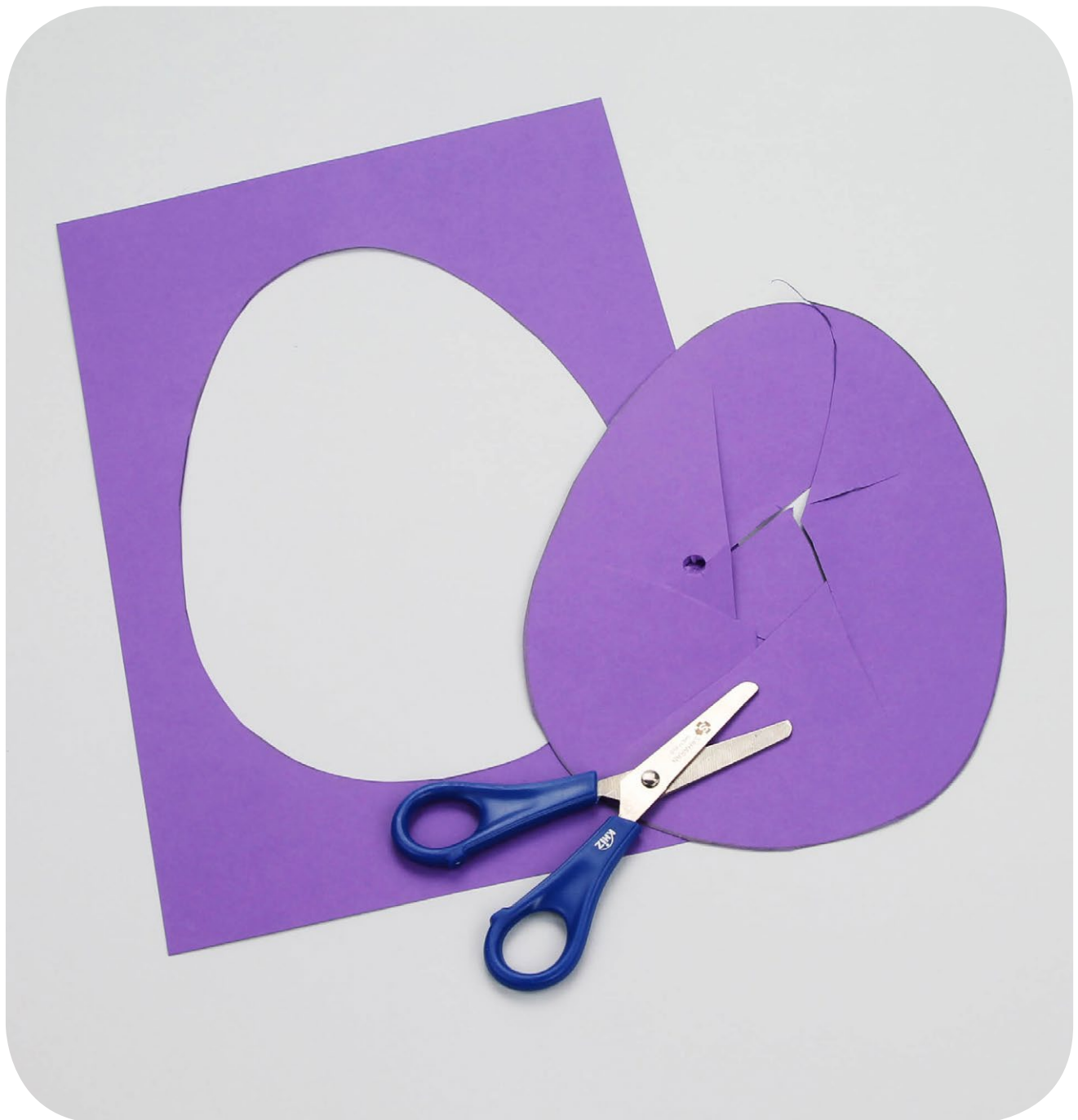

Step 2.

Cut the egg shape out of the middle of the card, without damaging the outer rim. This would leave you with an A4 frame of card with an egg shape cut out of it.



Step 3.

Cut strips of wrapping paper into two sets; one long enough for the width of the card and one long enough for the length of the card.

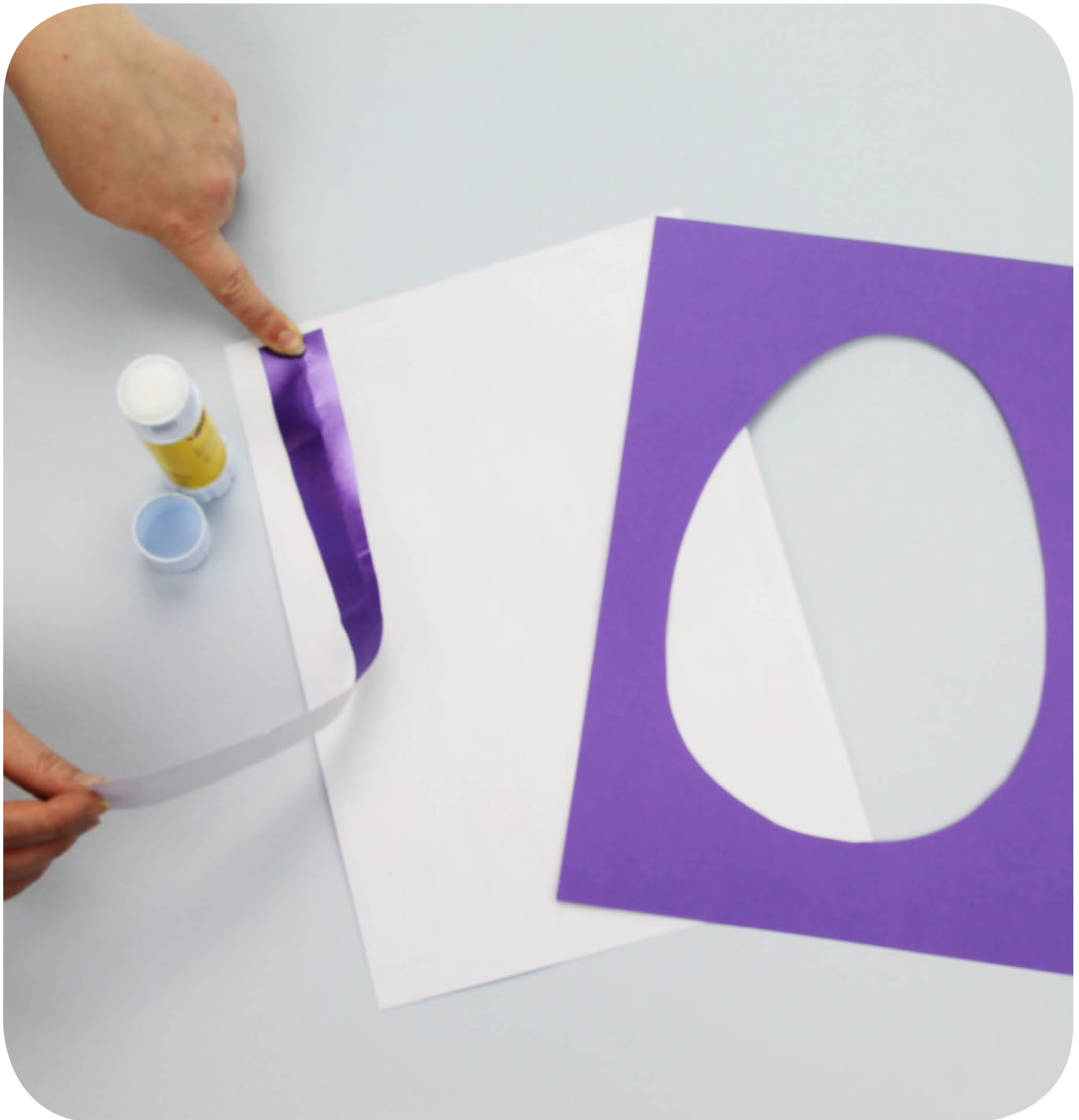

Step 4.

Place the long strips of wrapping paper vertically onto the A4 paper. Glue them down at one end only.



Step 5.

Using the other strips of wrapping paper, weave these over and under the vertical strips of paper.



Step 6.

Once the A4 paper is covered, glue all the edges of the woven paper down. Then trim the excess paper off to be flush with the A4 sheet.



Step 7.

Take the card egg frame and spread glue onto one side of it. Then stick this down on top of the woven sheet.



Step 8.

Finally, make a hole at the top of the egg frame using a hole punch.



Step 9.

Thread a loop of ribbon through to hang the woven paper egg from.